

**GROSS BUILDING AREA Floor 01 = 990.39 mp**  
**GROSS MEASURED AREA Floor 01 = 939.47 mp**  
**MAJOR VERTICAL PENETRATION Floor 01 = 54.34 mp**  
**FLOOR RENTABLE AREA Floor 01 = 873.33 mp**

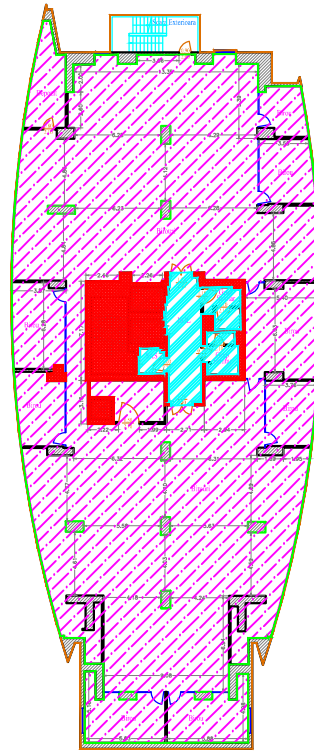

**USABLE AREA's**

**Office Area Floor 1 = 844.79 mp**  
**Terrace Area Floor 1 = 0.00 mp**  
**Storage Area Floor 1 = 0.00 mp**  
**Building Common Area Floor 1 = 0.00 mp**  
**Floor Common Area Floor 1 = 40.34 mp**

**Basic RENTABLE AREA's**

**Office Area Floor 1 = 885.13 mp**

T.C.G. co. 2001 SRL TOPO , CARTO & GIS Email: togsarban@yahoo.com		Beneficiar: S.C. NORD CITY S.R.L. Obiect: NORD CITY TOWER, Soseaua PIPERA Nr. 1/VII, Oras VOLUNTARI, Jud ILFOV -- Relevu si Calculatie BOMA Etaj 1 --	
OSM: 0722 274 443 FAX: 021/ 230 09 01			
Masurat	Radu Firmus	SCARA 1:200	PLAN: TCG-109/3-2011
Redactat	Radulescu Liviu		
Calcul BOMA	Radulescu Liviu	IAN. 2011	Plan de referinta :
Sef proiect	Ing.Sarban V.		System coordonate :

PLAN:  
Etaj 1